

## Mirage FX: 1 for all

ResMed's latest nasal mask—Mirage FX—is the most streamlined, unobtrusive nasal mask on the market; it's everything you've been waiting for all rolled into one.

### effortless fit

We understand that time is of the essence. Mirage FX features a Spring Air™ cushion and flexible, winged forehead support that work together to achieve a good seal in record time.

*Intuitive adjustments also save time and mean just about anyone can achieve a perfect, first-time fit.*

### simple solution

The perfect balance of sophisticated design and easy functionality, Mirage FX is the solution you've been waiting for: performance, ease-of-use and quality all rolled into one.

*Simply make one decision—Mirage FX—and the job is done.*

### mask for all

With Mirage FX, you'll fit more people the first time round with one mask, saving time, money and additional patient visits.

You'll find your patients will be more likely to accept and continue therapy thanks to a streamlined, comfortable mask that seals well.

*No matter who your patients are, Mirage FX is the one for all.*

**Mirage™ FX**  
NASAL MASK

[www.resmedmiragefx.com](http://www.resmedmiragefx.com)

# RESMED

## Great things come in small packages

Mirage FX's ease of use extends to its ease of ordering. With only four parts, managing your inventory is easier than ever.

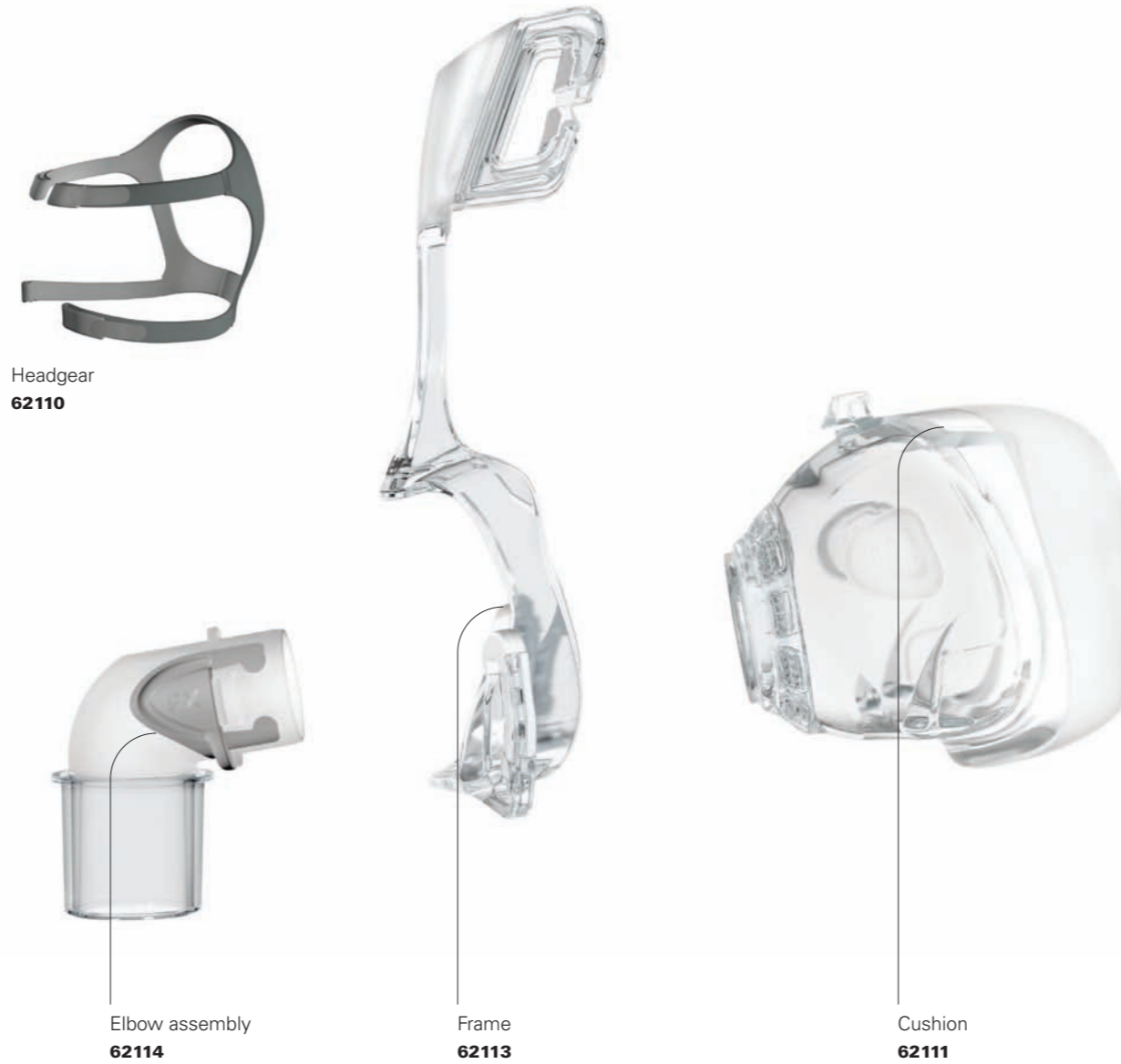

### Complete System

	Europe 1	Europe 2	Europe 3
Mirage FX	62100	62101	62102

**Europe 1:** English (UK), French, German and Italian (Switzerland)  
**Europe 2:** English, Danish, Finnish, Norwegian and Swedish  
**Europe 3:** English, Czech, Dutch (Belgium), French (Belgium), German (Belgium), Greek, Hungarian, Italian, Polish, Portuguese, Russian, Slovak, Spanish and Turkish

Manufacturer: ResMed Ltd 1 Elizabeth Macarthur Drive Bella Vista NSW 2153 Australia. Distributed by: ResMed Corp 9001 Spectrum Center Boulevard San Diego CA 92123 USA. ResMed (UK) Ltd 96 Milton Park Abingdon Oxfordshire OX14 4RY UK. See [www.resmed.com](http://www.resmed.com) for other ResMed locations worldwide. Mirage and Spring Air are trademarks of ResMed Ltd and are registered in U.S. Patent and Trademark Office. Velcro is a trademark of Velcro Industries B.V. © 2010 ResMed Ltd. Specifications may change without notice. 1014140/3 2010-11

For details, refer to the **Mirage FX Nasal Mask User Guide.**



# RESMED

## Effortless and effective

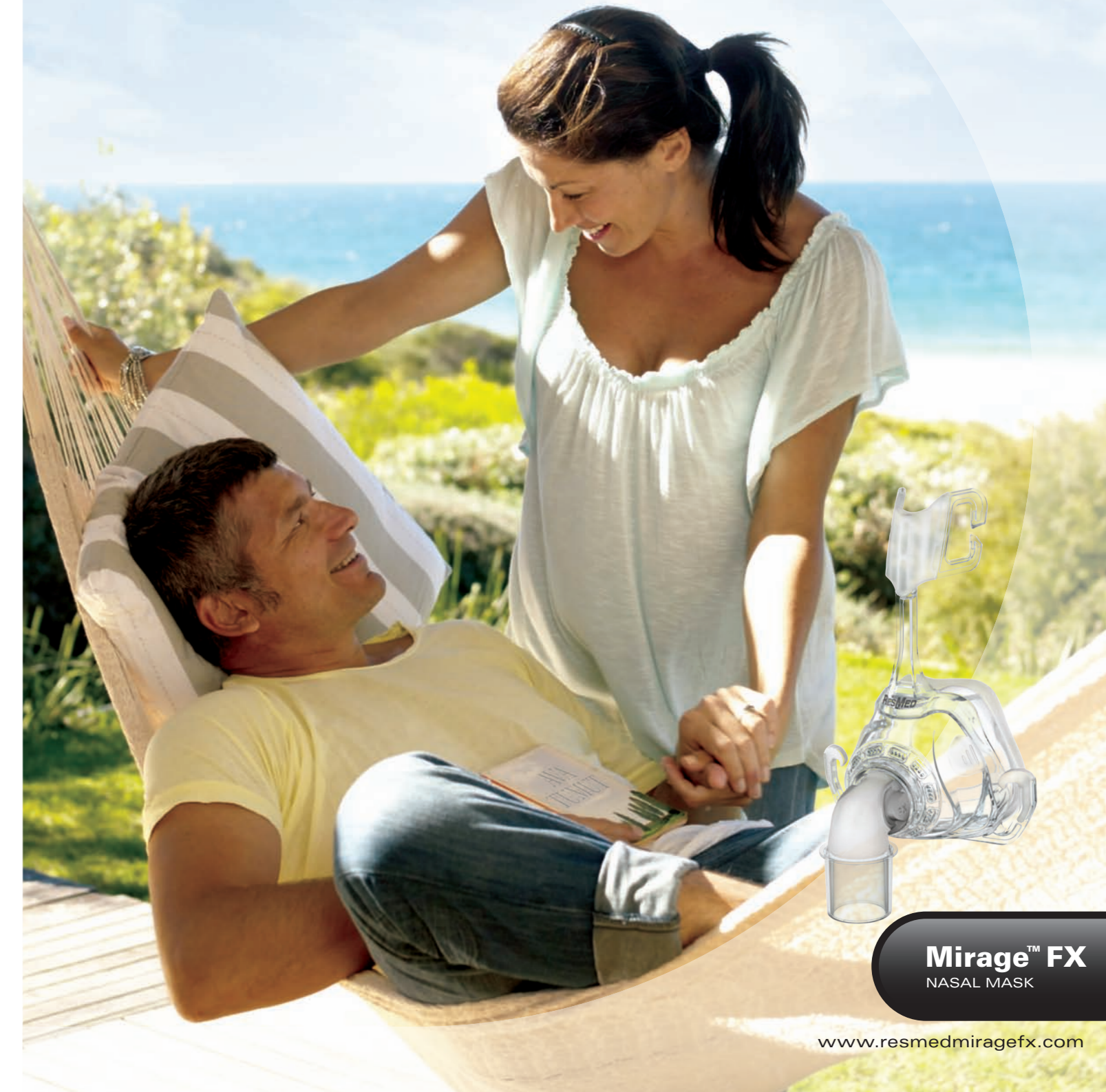

**Mirage™ FX**  
NASAL MASK

[www.resmedmiragefx.com](http://www.resmedmiragefx.com)

Streamlined and unobtrusive, Mirage FX helps to overcome the physical and emotional barriers to accepting therapy ... from first impressions to the first night of therapy and beyond.



**Preferred by 84% of patients over a leading competitor for overall performance**

ResMed User Evaluation Trials

## With Mirage FX, therapy has never been easier

Benefits for you ...

Sizing is a one-step process, with Mirage FX covering a wide range of facial characteristics in one mask ... so whoever your patients are, Mirage FX is the one for all.

Fitting is just as effortless. Mirage FX is intuitive to fit and adjust, so fitting takes virtually no time at all.

With only four parts, including headgear, you'll also save time on managing inventory.

**Mirage FX—puts your business first.**

... and your patients

The Mirage FX Spring Air cushion provides even pressure distribution and comfort for your patients, incorporating extra softness at the nasal bridge to reduce discomfort commonly felt in this sensitive area.

Your patients will also find Mirage FX easy to live with: it's easy to clean, wear and adjust ... and being one of the lightest nasal masks on the market, it won't weigh them down.

**Mirage FX—make it your number one mask.**

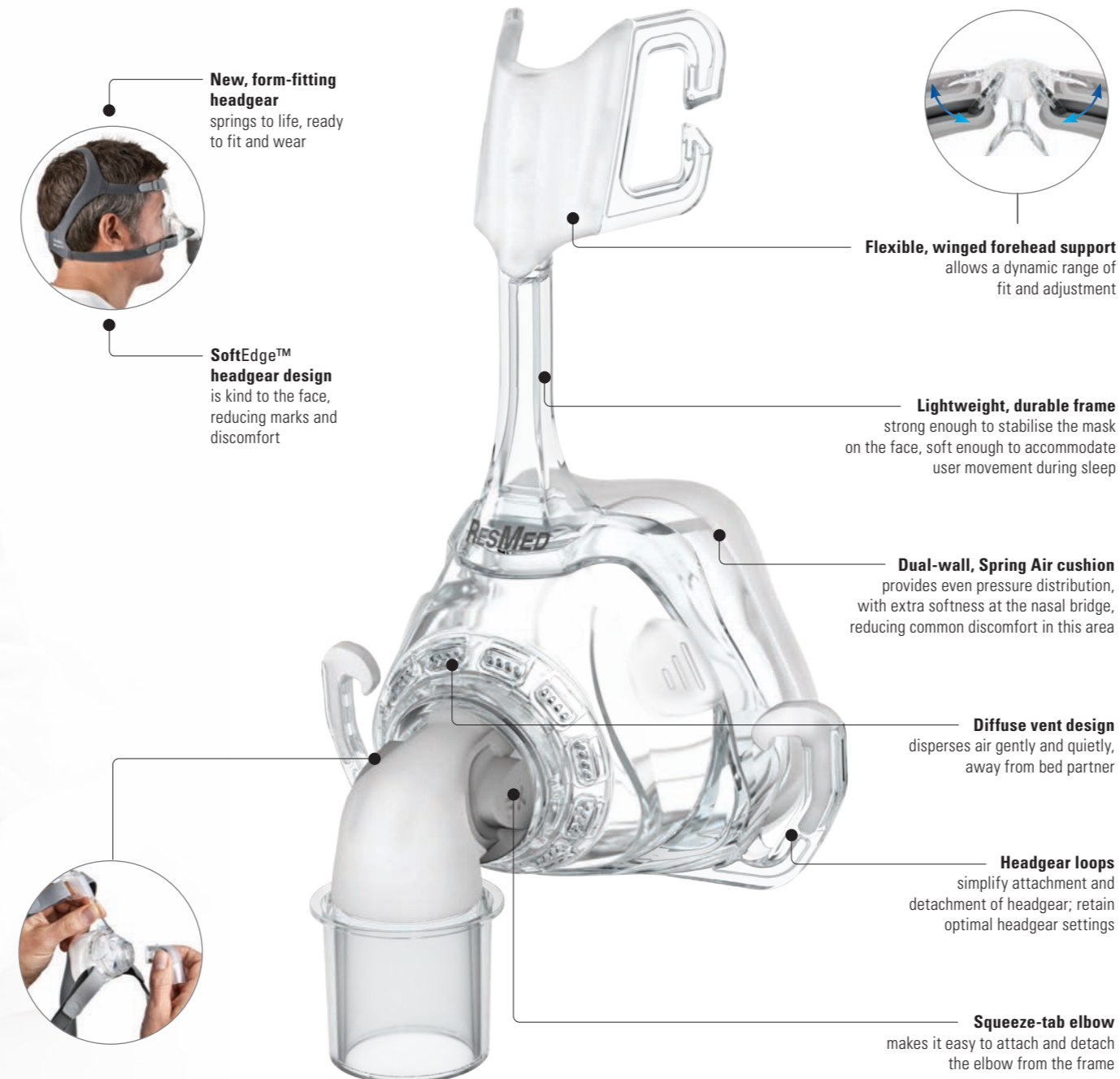

## Fitting Guide



- Prior to fitting the mask, remove the elbow from the mask by pressing the side tabs.



- Connect the elbow to the device air tubing.



- With both lower headgear straps released, hold the mask against the face and pull the headgear over the head.



- Bringing the lower straps below the ears, loop the headgear into the lower hooks on the mask frame.



- Unfasten the Velcro®, pull the upper headgear straps evenly until they are comfortable and firm, and reattach the Velcro.



- Repeat step 5 with the lower headgear straps.



- Attach the combined elbow assembly and air tubing to the mask by pressing the side-tabs and pushing into mask frame.
- Turn on the airflow device.

**Mirage™ FX**  
NASAL MASK

www.resmedmiragefx.com